

hammerthread™

Lesser toe deformity correction



Seeing is **Believing**

CARBON22™
A GLW, Inc. company



Effective and reliable

HammerThread is a Ø2.5mm cannulated, titanium implant, designed specifically for the correction of smaller toe deformities.

A small and effective portfolio of implants with appropriate design and length options for proximal and distal interphalangeal joint (PIPJ-DIPJ) arthrodesis.

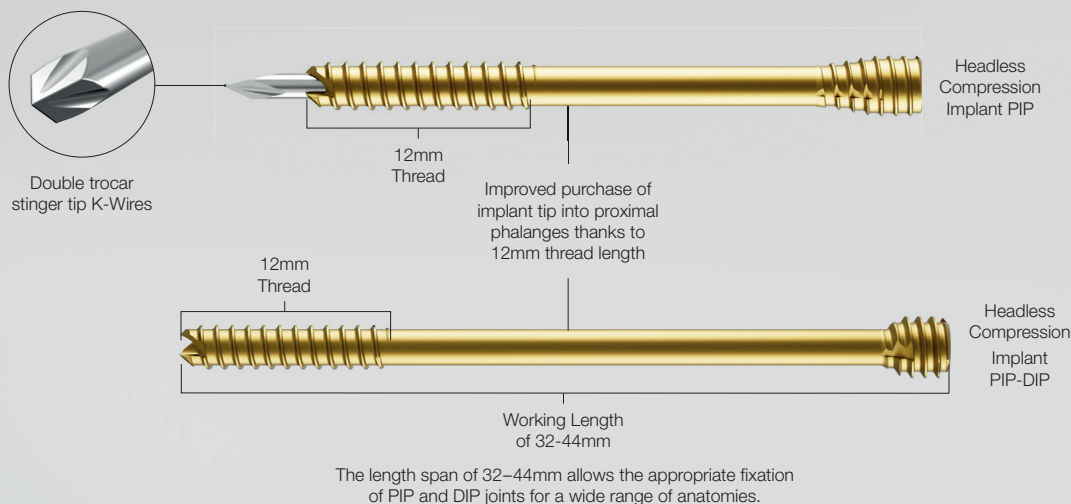

Superior precision

The HammerThread implants were designed to provide surgeons with a minimally invasive and reliable solution to address smaller toe deformities.

The system is comprised of Ø2.5mm titanium Ti64 implants that accept Ø1.3 K-Wires. This combination results in superior precision during insertion and ample stability during the reduction of proximal and distal interphalangeal joints (PIPJ-DIPJ).

The double stinger tip design of the K-Wires also allows for retrograde insertion of the HammerThread implants for both PIPJ and DIPJ fixation.

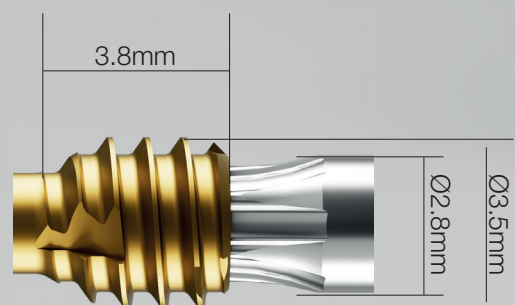
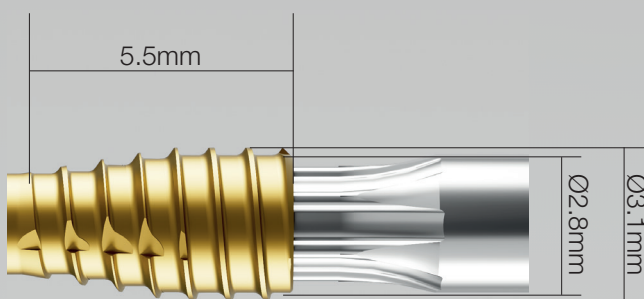

Reverse-Cutting Design
Expedites implant extraction

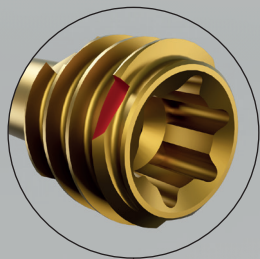

Forward-Cutting Design
Accelerates screwhead countersinking

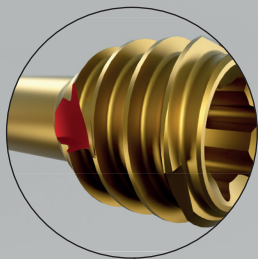

Large Cannulation
Accepts Ø1.3mm K-Wires

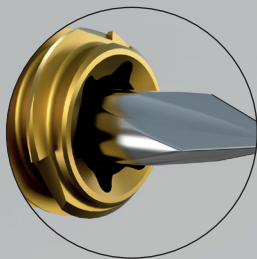

Tapered Head Design of PIP Screws
Seamless fixation of PIPJ

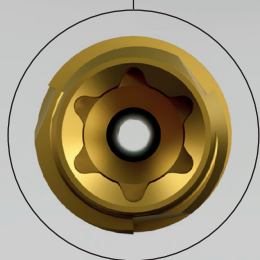
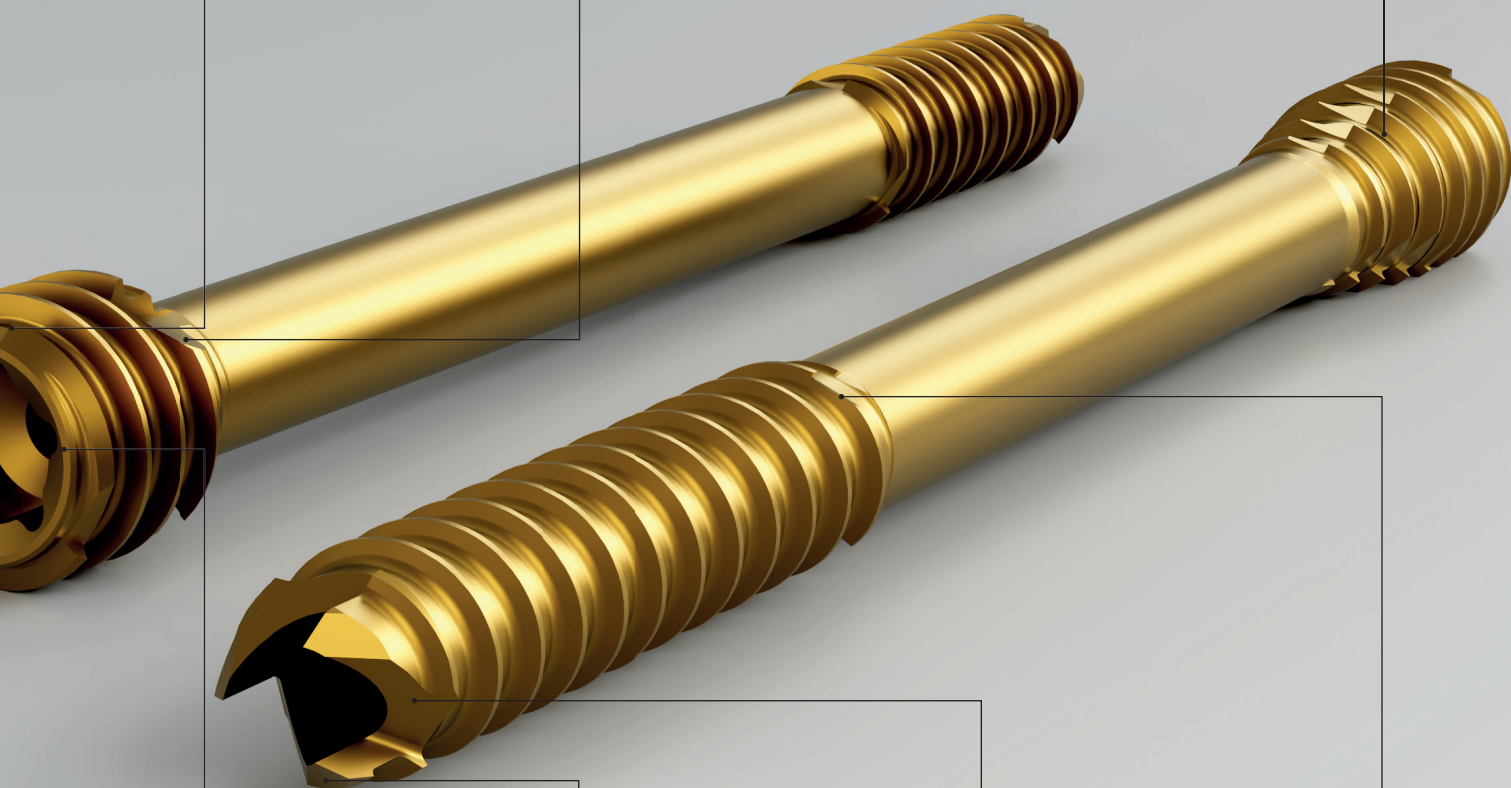
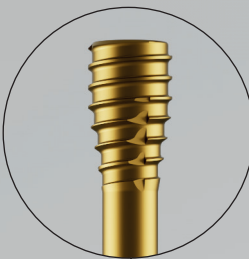

Torx Interface
Promotes a sturdy driver /implant interface

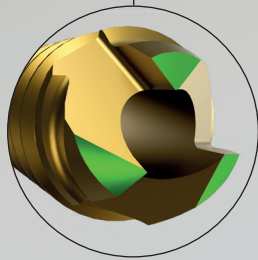

Self-Drilling Tip Design

Aggressive Tri-tip design
for unmatched cutting
performance

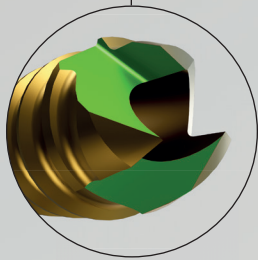

Self-Tapping Tip Design

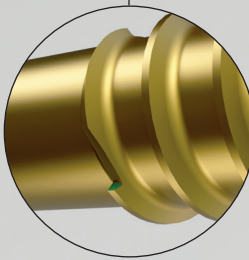

Reverse-Cutting Feature
Facilitates removal
of implant



Ready-to-use, everytime.

The instrumentation is provided in a sterile, ready-to-use instrument kit designed specifically for the correction of smaller toe deformities.

The instrument kit includes 4x double stinger tip Ø1.3mm K-Wires, a mini depth gauge, an AO-handle and a cannulated T8 driver with a tapered shaft that matches the implants outer diameter and allows the compression of the PIPJ only without requiring additional hole preparation.

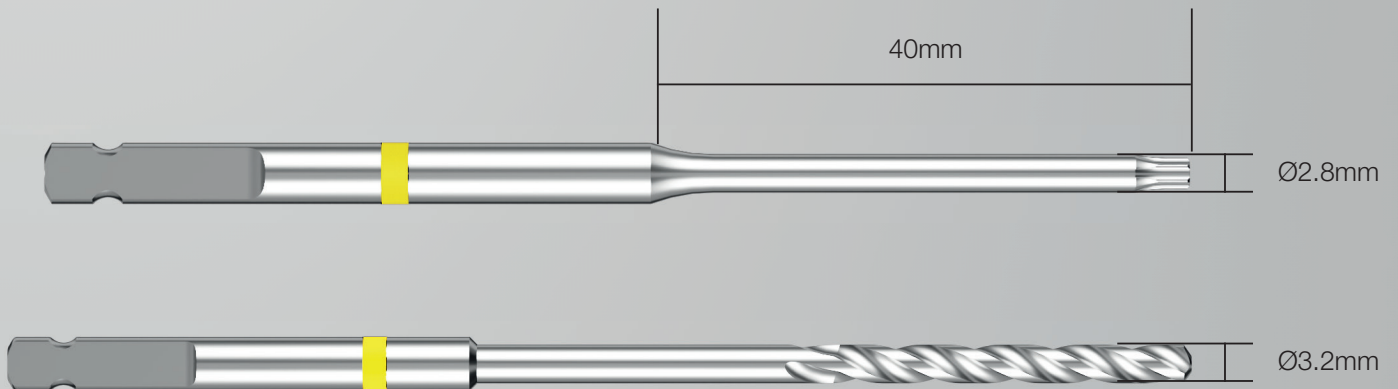



CAUTION: Federal (USA) law restricts this device to sale by or on the order of a surgeon. Rx only.

This document is intended solely for the use of healthcare professionals. This technique was developed in conjunction with healthcare professionals. A surgeon must always rely on his or her own professional clinical judgment when deciding whether to use a particular product when treating a particular patient. Carbon22 does not dispense medical advice and recommends that surgeons be trained in the use of any particular product before using it in surgery. The information presented is intended to demonstrate a Carbon22 product. A surgeon must always refer to the package insert, product label and/or instructions for use, including the instructions for Cleaning and Sterilization (if applicable), before using any Carbon22 product.

GLW, Inc, GLW Medical Innovation, and Hammerthread are trademarks of GLW, Inc. innov8ortho is the exclusive distributor of the Hammerthread.



Distributed by:

Innov8ortho, LLC
300 Sylvan Ave, 2nd Floor
Englewood Cliffs, NJ 07632
custsvc@innov8ortho.com



Legal Manufacturer:

GLW, Inc.
300 Sylvan Ave, 2nd Floor
Englewood Cliffs, NJ 07632

www.carbon22.net